

# EQUIPMENT SPECIFICATION

## BALL TABLES

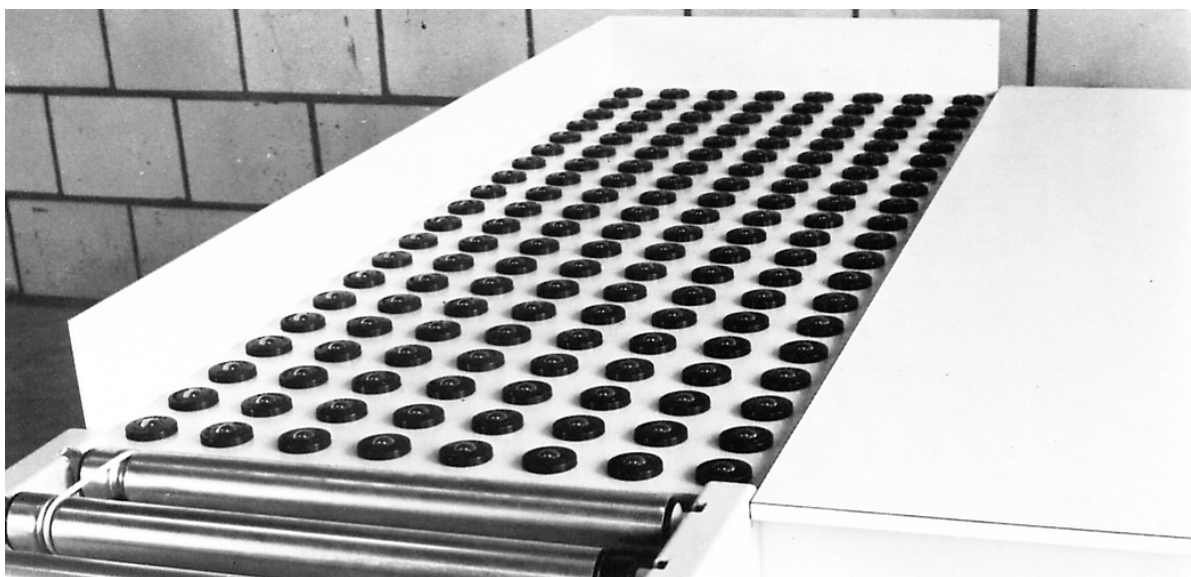

Application: Conveyance in any direction of items with a firm flat base.

Carrying surface for the balls:

Flat steel-plate, 3 or 4mm thick

Frames:

Press formed / fabricated to suit.

Table width:

Available to order

Ball diameter:

As specified in table below

Ball type:

Steel or synthetic

Design:

In the ball unit, the large ball is supported by several smaller balls resting in a semi-sphere made of steel. Due to this design, goods can be transported manual in any direction.

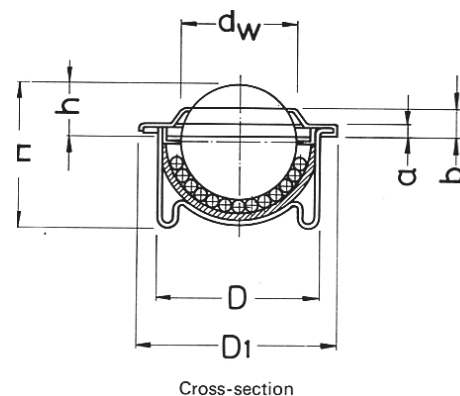

Type	dw	D	Size	D1	h	Size	H	a	b	Ball Capacity
KU15	15	24	0,042	31	9.5	0.2	21	2.8	6.3	20 kg
KU22	22	36	0,050	45	9.8	0.2	30.5	2.8	5.5	80 kg
KU30	30	45	0,050	55	13.8	0.3	36.5	4.0	8.3	150 kg
KU45	45	62	0,060	75	19.0	0.4	53.5	4.0	10.0	250 kg
KUM60	60	100	0,070	117	29.5	0.4	77.5	13.0	14.5	500 kg

Sheet No.1 BT

**VANRIET ROHACO**   
CONVEYOR AND ROBOTIC SOLUTIONS

Web address: [www.vanriet.co.uk](http://www.vanriet.co.uk)